

PRODUCT **S136**

elliptipar[®] with LED



SOLVING FOR LIGHT

elliptipar[®]
tambient[®]



THE LIGHTING **QUOTIENT[®]**

www.TheLightingQuotient.com

elliptipar... there is no equal

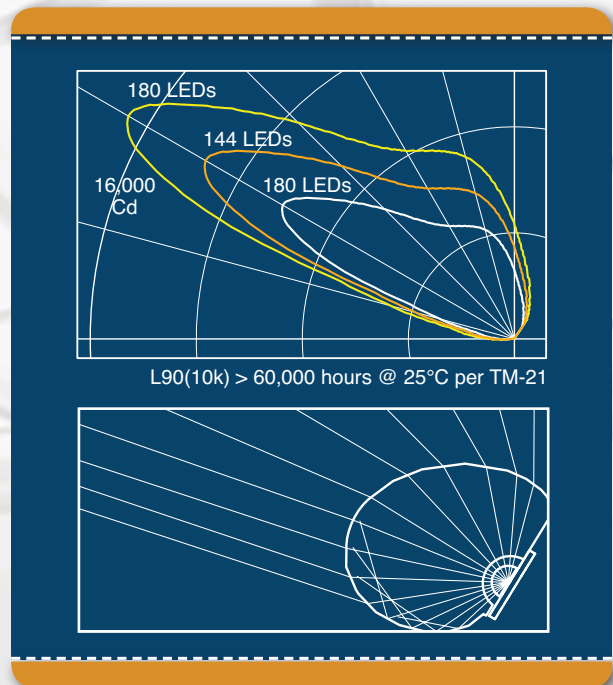
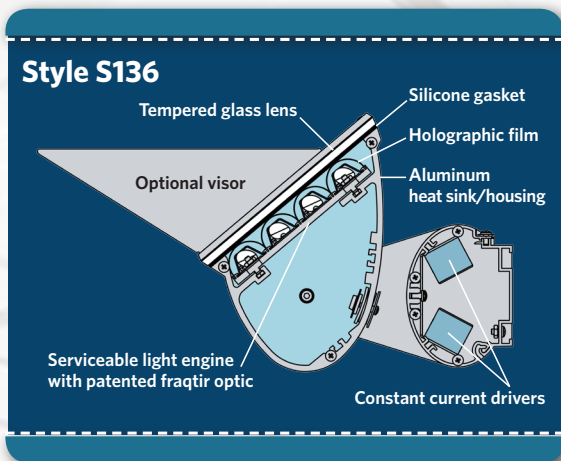

- **Patented fraqtir™ optics** – elliptipar’s premiere LED optical system – delivers light to the target, minimizing spill light and glare
- **Asymmetric forward throw and wide lateral distribution** – produces uniform illumination on surfaces, permitting larger on-center spacing
- **High light output** – 24,800 lumens delivered based on 180 LED fixture @ 4000K/70+CRI
- **Adjustable and lockable aiming** – aiming index allows constant aiming from fixture to fixture, locking set screw retains position
- **Constant current drivers** – 120-277V universal voltage input with several dimming protocols available and easily accessible for wiring and service
- **347V** for Canada now available
- **Mounting options** – surface, cantilever, 1-way, and 2-way uplight pendants
- **Natatorium option** – provides indirect illumination for the space from the perimeter, eliminating glare for swimmers while facilitating access for cleaning
- **Multiple color temperature and CRI choices** – 2700K, 3000K, 3500K, or 4000K at 70, 80 or 90+CRI
- **Excellent lumen maintenance** L90(10k)>60,000 hours @ 25°C per TM-21
- **CSA certified** for damp locations
- **U.S. Patents 8,465,190, D468,473 S;** foreign patents pending.

SOLVING FOR LIGHT
 elliptipar®
 tambient®
 THE LIGHTING QUOTIENT®

S Mount 1/10 scale

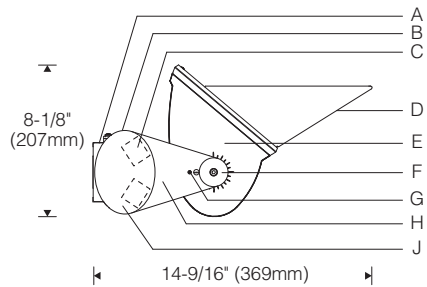

Cantilever
(X mount)

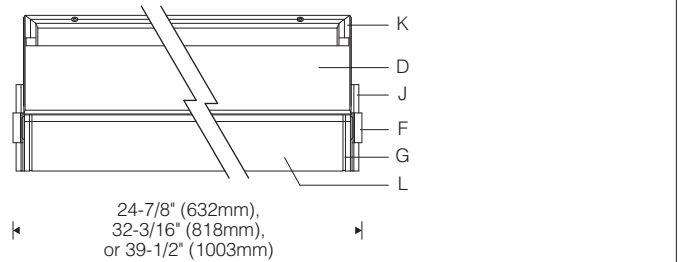

Mounting Plate (S mount)

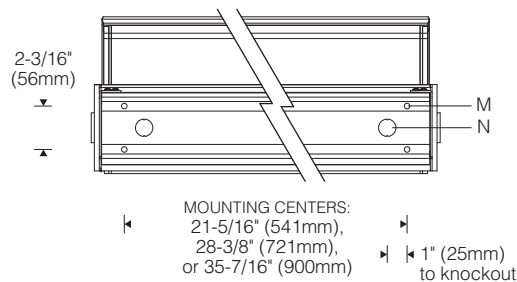

Installation (S mount)

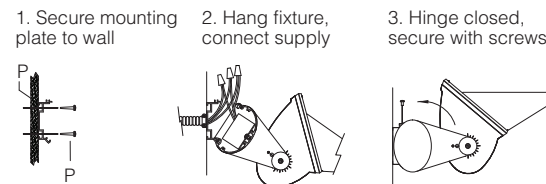

Specifications

- | | | | |
|--|---------------------------------------|--|---|
| A Extruded aluminum mounting plate/driver cover | E Die-cast aluminum end plates | J Aluminum oval end plates | M 9/32" dia. mounting holes, S mount only |
| B Extruded aluminum oval driver housing | F Decorative knob | K Mitered extruded aluminum door frame with microprismatic tempered glass lens, silicone gasket | N 7/8" dia. conduit entries, S mount only |
| C Integral electronic driver | G Locking set screw | L Extruded aluminum heat sink/housing | P Support structure and mounting fasteners by others |
| D Formed aluminum cutoff visor | H Aluminum side arms | | |

Optic Assembly:

Two-piece extruded aluminum heat sink/housing and light engine. Exterior heat sink anodized for maximum emissivity. Removable interior extrusion treated to maximize thermal conductivity. Precision formed asymmetric optical light bar of high temperature, water-clear acrylic. Tempered microprismatic glass lens with elliptical distribution holographic diffuser; maximizes lateral distribution without disturbing asymmetric forward throw.

Finish:

Painted surfaces – 6 stage pretreatment and electrostatically applied thermoset polyester powder coating for a durable abrasion, fade and corrosion resistant finish. Formed aluminum visor.

Extruded aluminum heat sink/housing, yoke, door frame and decorative end plates are finished in semigloss white. All luminaire hardware is stainless steel.

Mounting:

S mount – mounting plate/driver cover secures to wall. Uplight cantilever mounting assembly ordered separately; specify **X** mount. Upright one-way cluster pendant assembly ordered separately (see Accessories); specify mounting **1**.

Electrical:

Use 90°C wire for supply connections. Integral electronic HPF constant current driver. For complete driver specifications, see website, reference document MA-1303.

Standard:

CSA certified to UL1598, UL8750, CSA C22.2 for dry locations; specify **VP** option for damp locations. Where pendant or cantilever may be exposed to wind, consult factory. 5 year warranty, maximum ambient temperature 40°C (104°F).

Features

- Maintains over 90% of initial light output after 60,000 hours
- 2700K through 4000K at 70+, 80+ or 90+ CRI
- All aluminum and stainless steel construction
- Fully adjustable and lockable aiming with aiming index
- Universal voltage drivers and light engines are serviceable for replacement or upgrade



Performance

fraqtir technology uses a combination of refraction and total internal reflection, creating a distribution of light ideal for illuminating surfaces uniformly. Glare is minimized while light delivered to the target is maximized, resulting in high application efficiency.

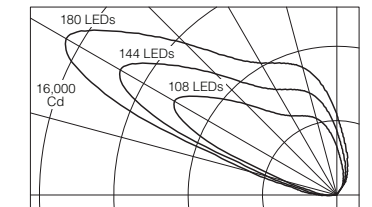

L90(10k) > 60,000 hrs @ 25°C per TM-21

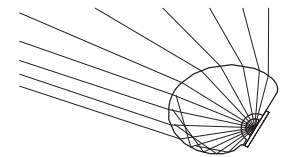

For photometric and lumen maintenance reports, visit thelightingquotient.com



